

NOTE: all insulation to be HCFC free.

NOTE: all insulation to be HCFC free.

Solid party wall type 1.1 in accordance with Part E of the Building Regulations 2003. 215mm thk. dense aggregate concrete blocks (density 1840kg/m³) with 10mm c/s mortar. Mass per unit area including finish 415kg/m².

13mm lightweight plaster, mass per unit area 10kg/m², on both sides

15mmx65mm polystyrene perimeter strip continuous at all wall/screed junctions.

NOTE: THE PERFORMANCE OF ALL PARTY WALLS RELY ON THE QUALITY OF WORKMANSHIP AND MATERIALS AND PARTICULAR ATTENTION IS DRAWN TO FULL AND PROPER COMPLIANCE WITH THE REQUIREMENTS OF BUILDING REGULATION No. 7.

THE CONTRACTOR SHALL ENSURE THAT ALL JOINTS ARE PROPERLY FILLED AND FLUSH POINTED BOTH HORIZONTALLY AND VERTICALLY. Ex. 60 X 25mm SW pencil rounded skirting with all corners chamfered.

6mm thk. gap filled with flexible sealant

Min 65 thick sand/cement floating screed with mesh reinforcement (min cover 25mm) to BS4483, reinforcement to pass through all jointing in the screed.

75mm insulation with all joints sealed and taped to provide vapour barrier, to achieve max. u-value of 0.25W/m²K.

'Visqueen Gas Barrier System' or similar approved gas membrane with min. joints lapped @ min. 150mm laid to manufacturer's recommendation.

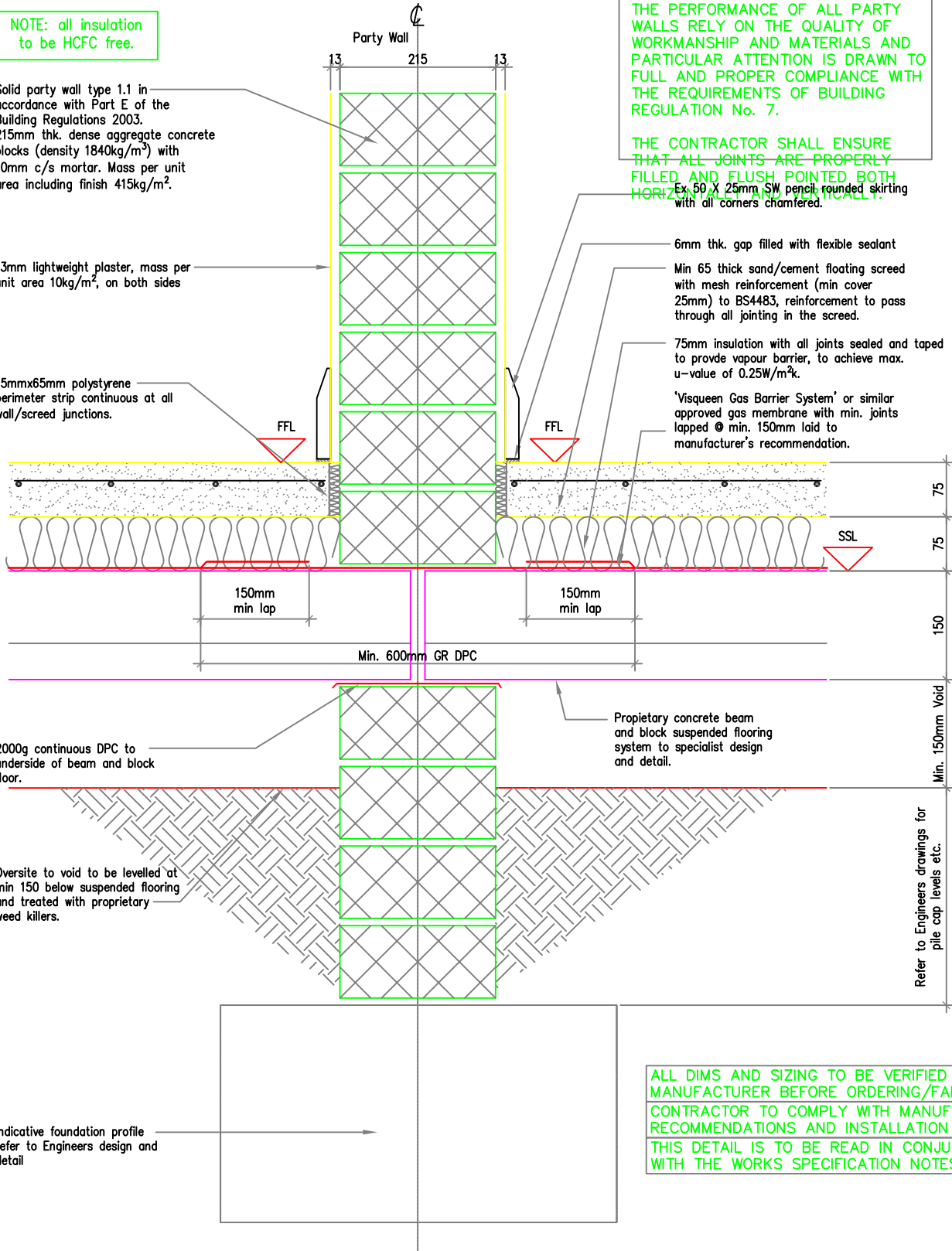

Indicative foundation profile refer to Engineers design and detail

ALL DIMS AND SIZING TO BE VERIFIED BY SPECIALIST MANUFACTURER BEFORE ORDERING/FABRICATION CONTRACTOR TO COMPLY WITH MANUFACTURERS RECOMMENDATIONS AND INSTALLATION GUIDES THIS DETAIL IS TO BE READ IN CONJUNCTION WITH THE WORKS SPECIFICATION NOTES

Sharon J. Ross, MBIAT.

Snr. Architectural Technologist. Mobile: 07960 152 845

Project: Station Road, Traditional construction

This document was created with Win2PDF available at <http://www.daneprairie.com>.
The unregistered version of Win2PDF is for evaluation or non-commercial use only.